

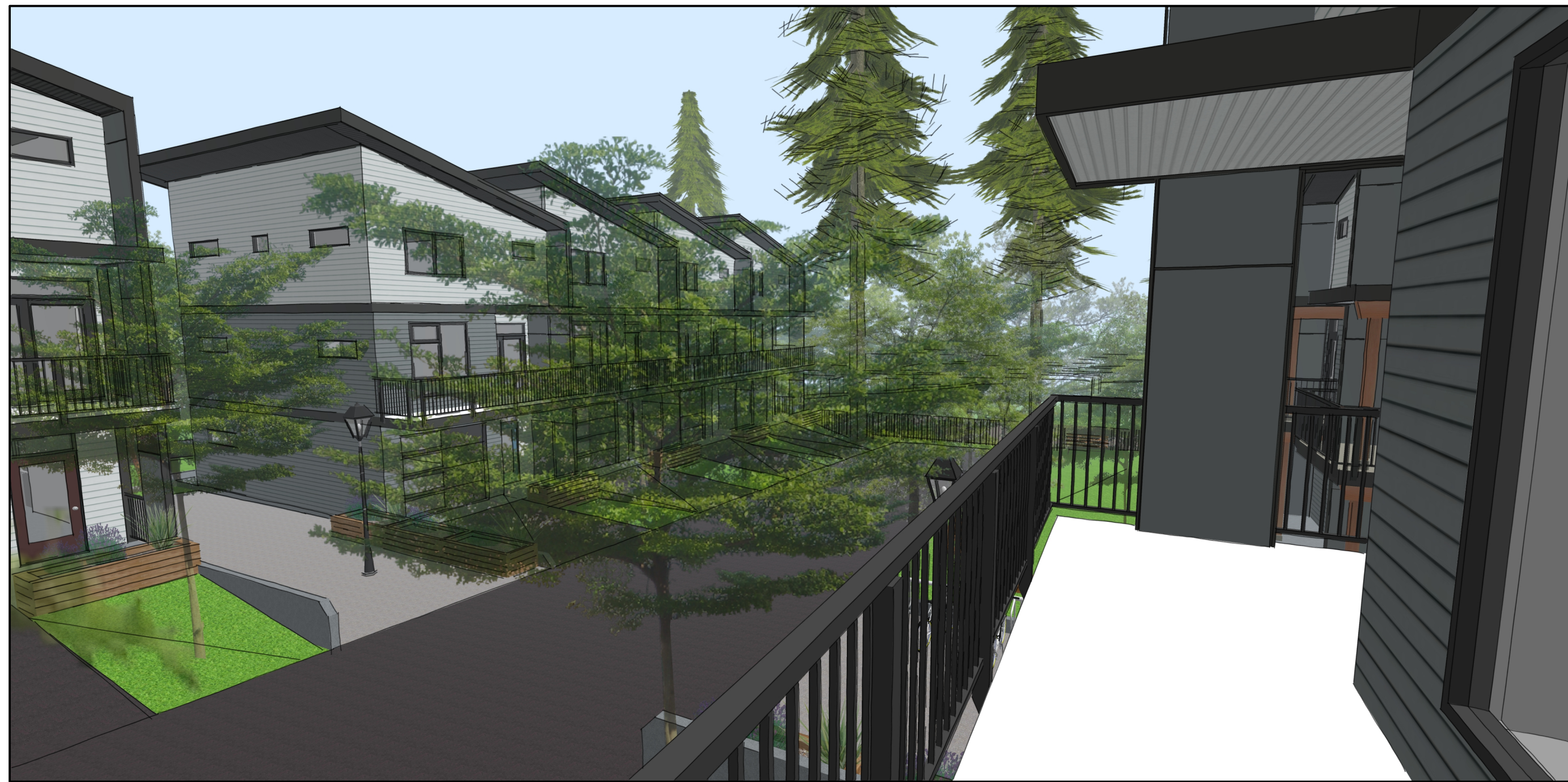

1 Looking down North Lane
N.T.S.



2 Looking at Building 2 Typical Front
N.T.S.



3 Looking down North Lane from Balcony
N.T.S.



4 Typical Front Entrance
N.T.S.

No.	Date	Issue Notes
01	2021 05 11	Pre-DP Meeting
02	2021 08 13	DP Application
03	2021 10 07	Coordination 01
04	2021 11 29	DP Revised
05	2022 03 02	DAP Letter Response
06	2022 04 18	Landscape Plan Revised
07	2022 06 09	Project Status
08	2023 02 06	Comp. Letter Response

No.	Date	Revision Notes
-	-	-

Clayburn Townhome Development
Nanaimo

6040 Hammond Bay Road, Nanaimo, B.C. V9T 5M4
Lot 5, District Lot 25G, Wellington District, Plan 11632

Project:

RECEIVED
DP1247
2023-FEB-06
Current Planning

Sheet Title:
Building A
3D Perspectives

Drawn: RH	Checked: RH
--------------	----------------

Job No.: 2102	Sheet No.:
Scale: As Noted	A0.2
Date: Feb 6, 2023	

CAD File:
Clayburn - Building type A & Site 02.vwx



1 Typical Rear
N.T.S.



2 Typical Garage Entrance
N.T.S.



3 Typical Front Entrance
N.T.S.



4 Typical Balcony
N.T.S.

No.	Date	Issue Notes
01	2021 05 11	Pre-DP Meeting
02	2021 08 13	DP Application
03	2021 10 07	Coordination 01
04	2021 11 29	DP Revised
05	2022 03 02	DAP Letter Response
06	2022 04 18	Landscape Plan Revised
07	2022 06 09	Project Status
08	2023 02 06	Comp. Letter Response

No.	Date	Revision Notes
-	-	-

Project: **Clayburn Townhome Development**
Nanaimo

6040 Hammond Bay Road, Nanaimo, B.C. V9T 5M4
Lot 5, District Lot 25G, Wellington District, Plan 11632

RECEIVED
DP1247
2023-FEB-06
CURRENT PLANNING

Sheet Title:
Building B
3D Perspectives

Drawn: RH	Checked: RH
Job No.: 2102	Sheet No.:
Scale: As Noted	A0.2
Date: Feb 6, 2023	
CAD File: Clayburn - Building type A & Site 02.vwx	